

# PIPE CLAMPS

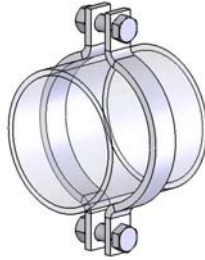

**PIPE CLAMP**

PIPE SIZE		BOLT SIZE	MATERIAL SIZE
(STL)	O.D.		
1/2"	7/8"	5/16"	1/8" x 1"
3/4"	1"	5/16"	1/8" x 1"
1"	1 - 3/8"	5/16"	1/8" x 1"
1 - 1/4"	1 - 5/8"	5/16"	1/8" x 1"
1 - 1/2"	1 - 7/8"	5/16"	1/8" x 1"
2"	2 - 3/8"	3/8"	1/4" x 1"
2 - 1/2"	2 - 7/8"	1/2"	1/4" x 1"
3"	3 - 1/2"	1/2"	1/4" x 1"
3 - 1/2"	4"	1/2"	1/4" x 1"
4"	4 - 1/2"	5/8"	1/4" x 1-1/4"
5"	5 - 9/16"	5/8"	1/4" x 1-1/4"
6"	6 - 5/8"	3/4"	3/8" x 1-1/2"
8"	8 - 5/8"	3/4"	3/8" x 1-1/2"
10"	10 - 3/4"	7/8"	1/2" x 2"
12"	12 - 3/4"	7/8"	1/2" x 2"
14"	14"	7/8"	1/2" x 2-1/2"
16"	16"	7/8"	1/2" x 2-1/2"
18"	18"	1"	5/8" x 2-1/2"
20"	20"	1-1/8"	5/8" x 2-1/2"
24"	24"	1-1/4"	5/8" x 3"
30"	30"	1-3/4"	3/4" x 4"

- PIPE CLAMPS ARE NORMALLY USED TO SUPPORT SUSPENDED PIPE
- ATTACHMENT TO THE CLAMP MAY BE MADE WITH A WELDLESS EYE NUT
- CLAMP WITH O.D.'S NOT LISTED ABOVE ARE MADE TO ORDER

*AVAILABLE FINISHES:* PLAIN, PRIME COAT, ELECTRO GALVANIZED, HOT DIP GALVANIZED, T-304 AND T-316

**TRIPAC**

*A DIVISION OF TRIPAC MARKETING, INC.*

475 KLUIG CIRCLE • CORONA, CA 92880-6406  
 (800) 720-8771 • FAX: (888) 718-0696