

CASING SPACERS

SUBMITTAL SPECIFICATIONS

| | | | | | | | |
|--|--------------------------------|---------------------------------|---------------------------------|--|---------------------------------|--------------------------------|---------------------------------|
| <input type="checkbox"/> A8G-1 | <input type="checkbox"/> A8G-2 | <input type="checkbox"/> A12G-1 | <input type="checkbox"/> A12G-2 | <input type="checkbox"/> C8G-2 | <input type="checkbox"/> C12G-2 | <input type="checkbox"/> S8G-2 | <input type="checkbox"/> S12G-2 |
| A = PAINTED STEEL CASING ISOLATOR A* SERIES SPACERS ARE PAINTED WITH A RUST INHIBITING PAINT | | | | C = COATED STEEL CASING ISOLATOR *C* SERIES ARE COATED 10 TO 16 MIL. FUSION BONDED PVC COATING. | | S = STAINLESS CASING ISOLATOR | |
| 8 = 8" WIDE STEEL BAND 12 = 12" WIDE STEEL BAND G = GLASS REINFORCED RUNNERS 1 = 1" WIDE RUNNERS 2 = 2" WIDE RUNNERS | | | | | | | |

LINER

| MATERIAL | THICKNESS MIN. | HARDNESS | DIELECTRIC STRENGTH 1/8" SURGE TEST | DIELECTRIC STRENGTH STEP BY STEP TEST | WATER ABSORPTION |
|--------------------|----------------|---------------------|-------------------------------------|---------------------------------------|------------------|
| POLYVINYL CHLORIDE | 0.090 | DUROMETER "A" 85-90 | 60,000 V MIN. | 58,000 V MIN. | 1% MAX. |

RUNNER SPECIFICATIONS

| TENSILE STRENGTH KG/CM ² | FLEXURAL STRENGTH KG/CM ² | COMPRESSION STRENGTH | DEFLECTION TEMP AT 264 PSI |
|-------------------------------------|--------------------------------------|----------------------|----------------------------|
| 17,600 PSI | 25,300 PSI | 18,000 PSI | 405°F |

OPTION

FUSION BONDED PVC COATING

| DUROMETER SHORE A2 | OPERATING TEMP MAX. | AGING PROPERTIES | ELECTRICAL PROPERTIES | RESISTANCE SALT SPRAY | RESISTANCE ACIDS | RESISTANCE ALKALIES |
|--------------------|---------------------|------------------|-----------------------|-----------------------|------------------|---------------------|
| 80 | 150°F | EXCELLENT | 1,380 V/mil. | EXCELLENT | GOOD | GOOD |

GENERAL DESCRIPTION "A" AND "C" SERIES: 14 GAUGE HOT ROLLED AND PICKLED MILD STEEL. FLANGES OF THE SPACER ARE DEEP EMBOSSED AND THE CORNERS ARE CHAMFERED. THE "AND COATED AND PAINTED RISERS ARE MADE OUT OF 10 GAUGE STEEL AND MIG WELDED TO BAND. **"S" SERIES:** 14 GAUGE 304 STAINLESS STEEL. FLANGES OF THE SPACER ARE DEEP EMBOSSED AND THE CORNERS ARE CHAMFERED. STAINLESS STEEL RISERS ARE MADE OUT OF 10 GAUGE 304 STAINLESS STEEL AND MIG WELDED TO BAND.

HARDWARE: STUDS 5/16"-18 x 2 1/2", HEX NUTS 5/16"- 18, WASHERS 5/16" SAE 2330. SUPPLIED IN STEEL PLATED AND 304 STAINLESS STEEL.

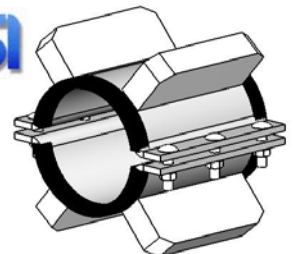

CASING SPACERS ARE MANUFACTURED BY PIPELINE SEAL AND INSULATOR, INC HOUSTON, TEXAS FACILITY THAT HAS A REGISTERED ISO 9001:200 QUALITY MANAGEMENT SYSTEM. STOCKED AND DISTRIBUTED BY TRIPAC IN THE CORONA, CALIFORNIA WAREHOUSE.

TRIPAC

A DIVISION OF TRIPAC MARKETING, INC.

475 KLUG CIRCLE • CORONA, CA 92880-6406
(951) 280-4488 • FAX: (951) 272-4445